



AGM

FDC Series are Deep Cycle AGM batteries specifically designed for frequent discharge deep cycle application. With non-spillable design and maintenance free, AGM FDC Series offer low self-discharge and ensure a maximum service life with high resistance to cycles. Thanks to carbon additives, these batteries can perfectly be used with good performance without being 100% charged. This range offers reliable performance for electric vehicle and other applications such as golf cart, aerial work platform, cleaning machine, marine, solar energy...

FEATURES

- DEEP CYCLE AGM TECHNOLOGY (VRLA)
- NON SPILLABLE & MAINTENANCE FREE
- NO ACID HANDLING
- DEEP CYCLE DESIGN FOR HIGH CAPACITY AND MAXIMUM LIFE
- REINFORCED GRID/PLATES DESIGN FOR OPTIMAL CYCLIC USE
- ROBUST, SAFE & RELIABLE
- CARBON ADDITIVES TO PERFORM IN PARTIAL STATE OF CHARGE (PSOC) AND TO INCREASE CHARGING EFFICIENCY
- LOW SELF-DISCHARGE RATE FOR LONGER SHELF LIFE

TERMINAL

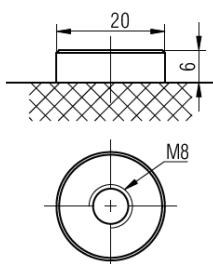

SPECIFICATION

VOLTAGE	6v	CAPACITY (100h)	270Ah
CAPACITY (25A)	530min	CAPACITY (20h)	245Ah
CAPACITY (75A)	145min	CAPACITY (10h)	232Ah
		CAPACITY (5h)	210Ah

Operating temperature

Discharge	-15°C ~ 50°C
Charge	0°C ~ 40°C
Storage	-15°C ~ 40°C

Charging instructions

Max current	61A
Float	6.8V - 6.9V
Cyclic	7.2V - 6.35V

DIMENSIONS & WEIGHT

LENGTH	243±2mm
WIDTH	187.5±2mm
TOTAL HEIGHT	275±2mm
GROSS WEIGHT	32.4kg

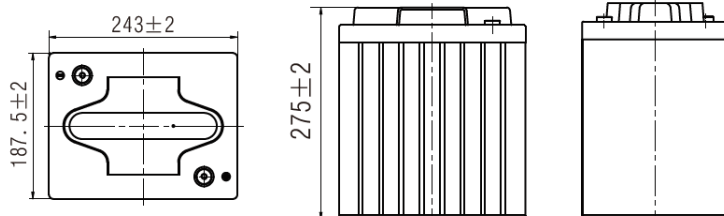

APPLICATIONS



FDC AGM CHARGING PROFILE

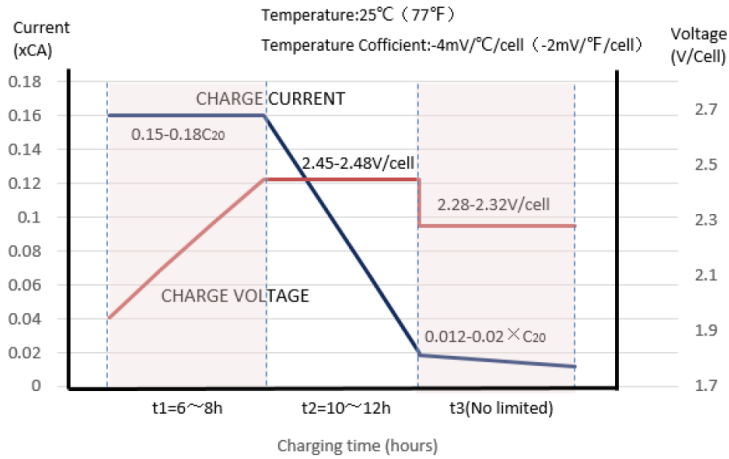

RELATIONSHIP OF OCV AND STATE OF CHARGE (25°C, 77°F)

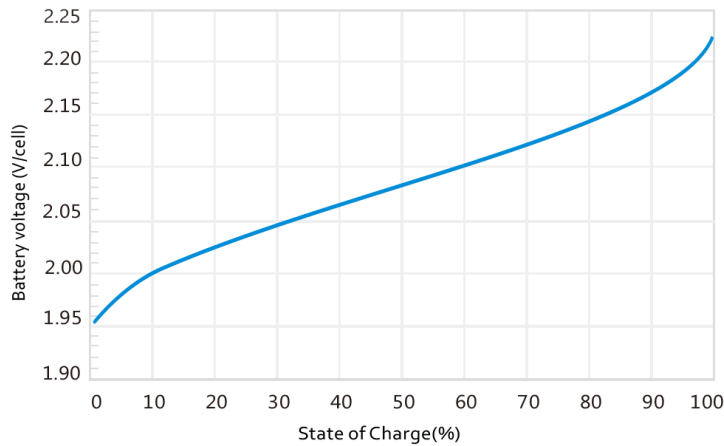

CYCLE LIFE IN RELATION TO DEPTH OF DISCHARGE

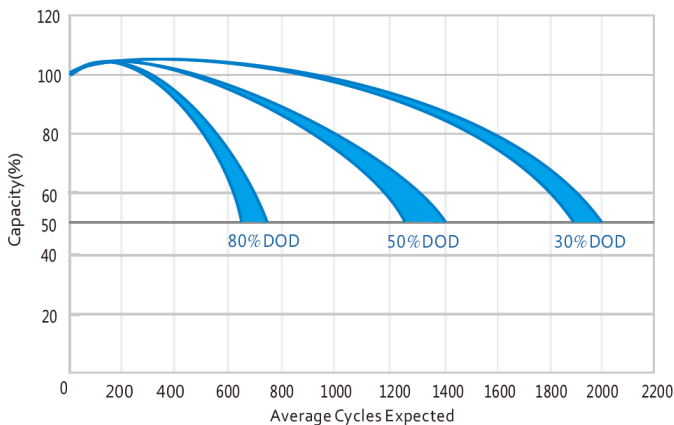

SELF-DISCHARGE CHARACTERISTIC

