

FDC-1275

Datasheet



SPECIFICATIONS

Voltage	Capacity	Reserve capacity
12 V	166 Ah (100hr)	280 min (25A)
	150 Ah (20hr)	70 min (75A)
	134 Ah (10hr)	
	120 Ah (5hr)	



OPERATING TEMPERATURE

-20°C to 45°C

At temperatures below 0°C maintain a state of charge higher than 60%.

CAPACITY AFFECT BY TEMPERATURE

40°C	105%
30°C	100%
0°C	80%

FDC Series are Deep Cycle liquid electrolyte batteries specifically designed for small traction applications (requiring deep discharges). With robust design made of thick positive & negative grid plates in a special alloy, the FDC Series offer low self-discharge and ensure a long service life with high resistance to cycles. This range is ideal for golf cart applications, aerial work platform, cleaning machine, solar.

CHARGE METHOD

Phase 1 (Constant current)

Constant current charge at 15~19.5 amperes until the battery voltage measures between 7.14~7.29 V/Battery(25°C) on charge voltage.

Phase 2 (Constant voltage)

Constant voltage charge at 7.14~7.29 V/Battery(25°C) until the current measures between 2.25~6.75 amperes.

Phase 3 (Constant current)

Constant current charge at 2.25~6.75 amperes until the battery voltage measures between 7.5~8.1 V/battery(25°C) or until dV/dt reaches to less than 0.035.

Do not install or charge batteries in a sealed or non-ventilated compartment. Constant under or overcharging will damage the battery and shorten its life as with any battery.

DIMENSIONS & WEIGHT

Length	329±2mm
Width	181±2mm
Total height	278±2mm
Gross weight	38.5kg
Electrolyte	6.8L

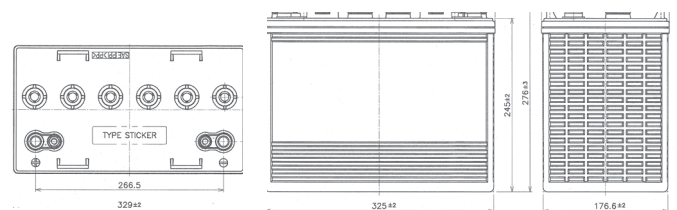

TERMINAL

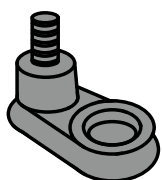

EHPT
(Embedded High Profil Terminal)

Terminal height	38mm
Torque value	11-12mm
Bolt terminal	M8

APPLICATIONS



Aerial work platform



Golf cart



Floor cleaning machine

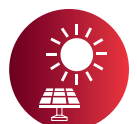

Solar

FDC-1275

Datasheet



SELF DISCHARGE DATA

Specific Gravity VS Time

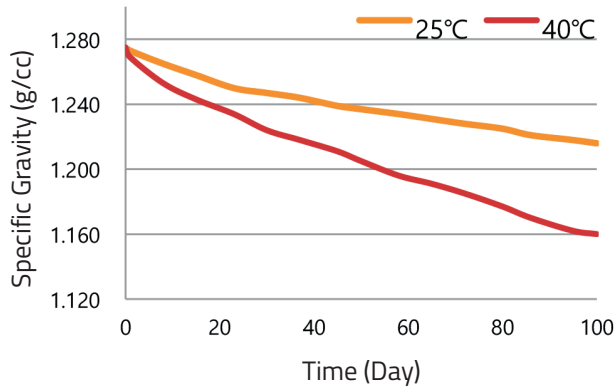

Voltage VS Time

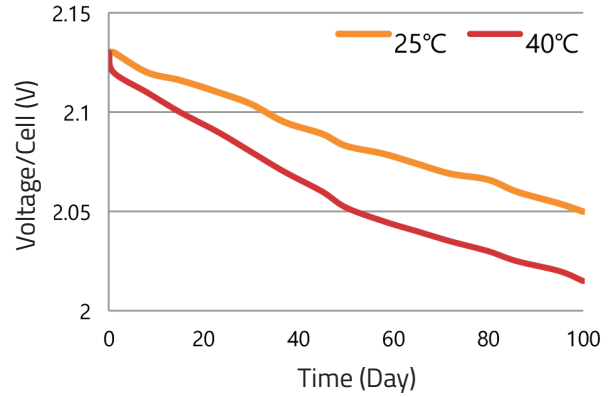

CAPACITY BY DISCHARGE CURRENT

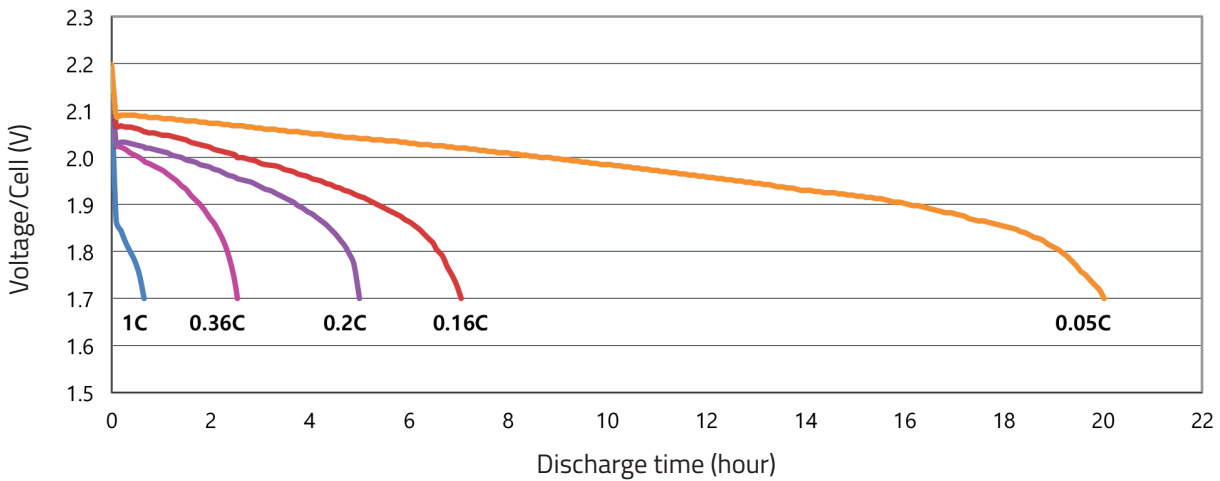

CYCLE LIFE IN RELATION TO DEPTH OF DISCHARGE

