

FDC-875

Datasheet



FLOODED

FDC Series are Deep Cycle liquid electrolyte batteries specifically designed for small traction applications (requiring deep discharges). With robust design made of thick positive & negative grid plates in a special alloy, the FDC Series offer low self-discharge and ensure a long service life with high resistance to cycles. This range is ideal for golf cart applications, aerial work platform, cleaning machine, solar.

CHARGE METHOD

Phase 1 (Constant current)

Constant current charge at 17~22.1 amperes until the battery voltage measures between 9.52~9.72V/Battery (25°C) on charge voltage.

Phase 2 (Constant voltage)

Constant voltage charge at 9.52~9.72V/Battery (25°C) until the current measures between 1.7~5.1 amperes.

Phase 3 (Constant current)

Constant current charge at 1.7~5.1 amperes until the battery voltage measures between 10~10.8V/battery (25°C) or until dV/dt reaches to less than 0.035.

Do not install or charge batteries in a sealed or non-ventilated compartment. Constant under or overcharging will damage the battery and shorten its life as with any battery.

TERMINAL

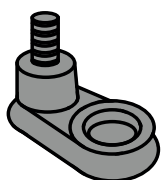

EHPT
(Embedded High Profil Terminal)

Terminal height	38mm
Torque value	11-12mm
Bolt terminal	M8

SPECIFICATIONS

Voltage	Capacity	Reserve capacity
8 V	170 Ah (20hr)	295 min (25A)
	145 Ah (5hr)	75 min (75A)

OPERATING TEMPERATURE

-20°C to 45°C

At temperatures below 0°C maintain a state of charge higher than 60%.

CAPACITY AFFECT BY TEMPERATURE

40°C	105%
30°C	100%
0°C	80%

DIMENSIONS & WEIGHT

Length	262±2mm
Width	181±2mm
Total height	278±2mm
Gross weight	28.6kg
Electrolyte	5.8L

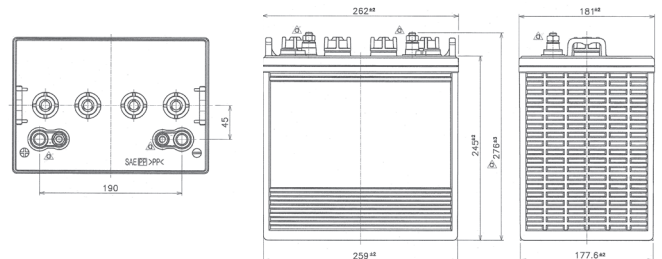

APPLICATIONS



Aerial work platform



Golf cart



Floor cleaning machine

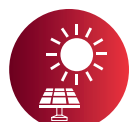

Solar

FDC-875

Datasheet



SELF DISCHARGE DATA

Specific Gravity VS Time

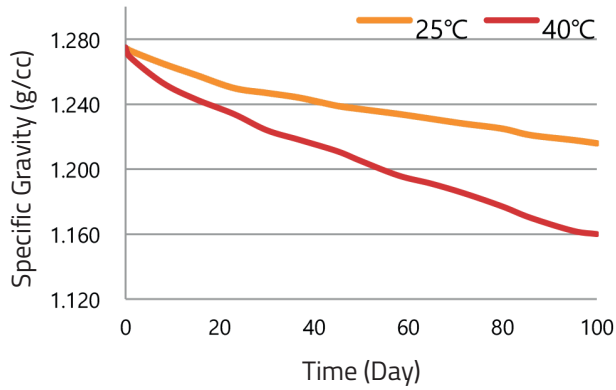

Voltage VS Time

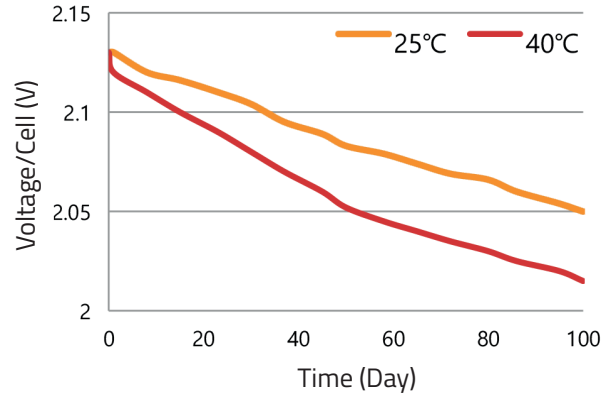

CAPACITY BY DISCHARGE CURRENT

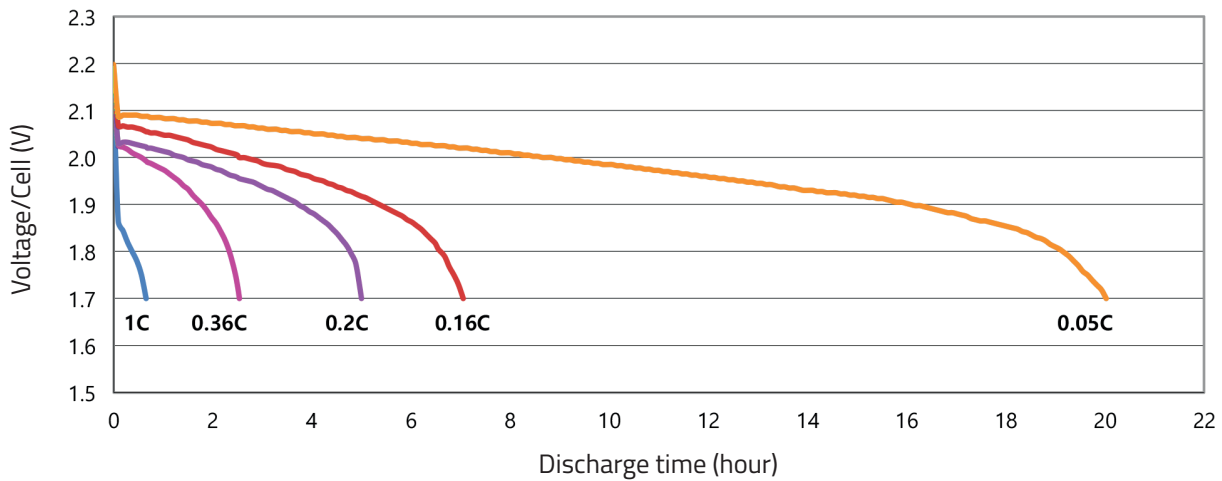

CYCLE LIFE IN RELATION TO DEPTH OF DISCHARGE

