

FFT12-100

Datasheet



AGM

NON-SPILLABLE

FFT batteries are a part of our FP General Purpose Series. Designed for applications that demand high levels of reliability and safety, FFT batteries offer a long service life up to 12 years. Thanks to their front terminal design, these batteries allow rapid installation and easy access for maintenance. These front terminal batteries are ideal for power cabinets 19" and 23" used by telecommunication companies.

DIMENSIONS & WEIGHT

Length	508±2mm
Width	110±2mm
Total height	238±2mm
Gross weight	32.0kg

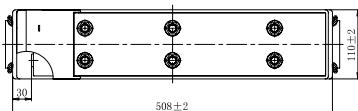
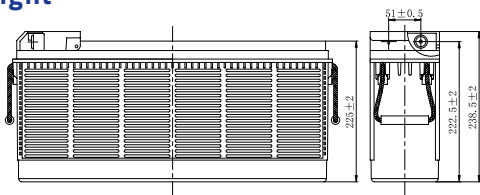

TERMINAL

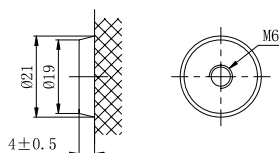

SPECIFICATIONS

Nominal voltage	12V (6 cells)
Nominal capacity	100.0Ah (10hr)
Design life	12 years at 25°C
Internal resistance	Approx 5.5mΩ
Terminal	T6
Max. discharge current	1000A (5 sec)
Reference capacity	106.0Ah (20hr, 1.80V/cell, 25°C) 100.0Ah (10hr, 1.80V/cell, 25°C) 96.8Ah (8hr, 1.75V/cell, 25°C) 87.0Ah (5hr, 1.75V/cell, 25°C) 64.3Ah (1hr, 1.60V/cell, 25°C)
Charge voltage	13.5V ~ 13.8V 25°C
Standby use voltage	Temperature compensation: -20mV/°C/Cell
Cycle use voltage	14.1V ~ 14.4V 25°C
	Temperature compensation: -30mV/°C/Cell
Operating temp. range	Discharge: -15°C ~ 50°C Charge: -20°C ~ 40°C Storage: -15°C ~ 40°C
Nominal operating temp. range	25°C ± 3°C
Self discharge	Can be stored for up to 6 months at 25°C and then recharging is recommended. Monthly self-discharge ratio is less than 3% at 25°C
Capacity affected by temp.	40°C 103% 25°C 100% 0°C 86%
Container material	A.B.S. UL94-HB UL94-V0 optional

APPROVALS

ISO9001 - Quality management system
ISO14001 - Environmental management System
Approved for transport by Air (IATA)
Designed in accordance with IEC 60896-21/22

APPLICATIONS



Telecom



UPS & data center

FFT12-100

Datasheet

CONSTANT CURRENT DISCHARGE (A) @25°C

F.V./Time	10min	15min	20min	30min	45min	1h	2h	3h	4h	5h	6h	8h	10h	20h
1.85V/cell	144.6	127.2	114.0	91.6	69.6	56.3	33.6	24.7	19.9	16.7	14.5	11.5	9.56	5.07
1.80V/cell	168.0	146.8	127.2	99.0	74.3	59.5	34.8	25.7	20.5	17.2	14.8	11.9	10.0	5.30
1.75V/cell	185.4	158.0	133.2	103.2	76.8	61.4	35.6	26.1	20.8	17.4	15.1	12.1	10.1	5.35
1.70V/cell	197.4	165.6	138.6	106.0	78.8	62.8	36.2	26.5	21.1	17.6	15.3	12.2	10.2	5.38
1.67V/cell	206.4	171.2	144.0	108.4	80.1	63.7	36.6	26.7	21.3	17.8	15.4	12.3	10.3	5.41
1.60V/cell	215.4	176.0	146.4	110.6	80.9	64.3	37.1	27.0	21.5	18.1	15.6	12.5	10.4	5.44

CONSTANT POWER DISCHARGE (W/CELL) @25°C

F.V./Time	10min	15min	20min	30min	45min	1h	2h	3h	4h	5h	6h	8h	10h	20h
1.85V/cell	270.0	239.9	217.2	176.4	135.2	109.7	65.8	48.6	39.3	33.1	28.7	22.9	19.1	10.1
1.80V/cell	310.0	273.2	238.8	187.8	143.1	115.3	67.7	50.4	40.3	33.9	29.3	23.6	20.0	10.6
1.75V/cell	336.7	290.5	247.7	194.2	146.6	118.5	69.0	51.0	40.7	34.2	29.7	23.9	20.2	10.7
1.70V/cell	350.5	300.2	255.8	198.3	149.9	120.8	70.1	51.6	41.2	34.4	30.0	24.2	20.3	10.7
1.67V/cell	365.1	309.1	264.7	202.4	151.7	122.2	70.8	51.9	41.5	34.8	30.2	24.4	20.5	10.8
1.60V/cell	370.4	311.5	265.3	203.8	151.9	122.3	71.1	52.2	41.7	35.2	30.6	24.6	20.7	10.8

DISCHARGE CHARACTERISTICS

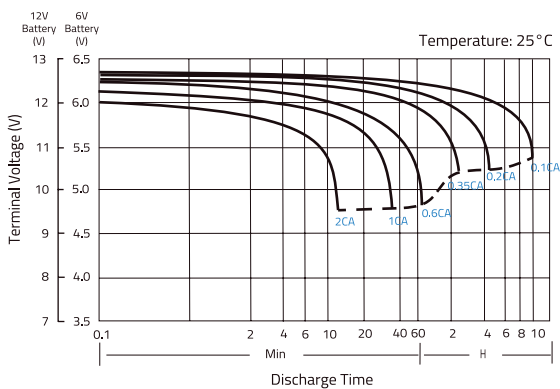

FLOAT CHARGING CHARACTERISTICS

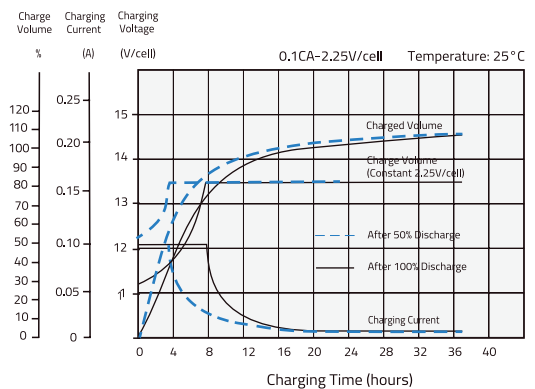

TEMPERATURE IN RELATION TO BATTERY CAPACITY

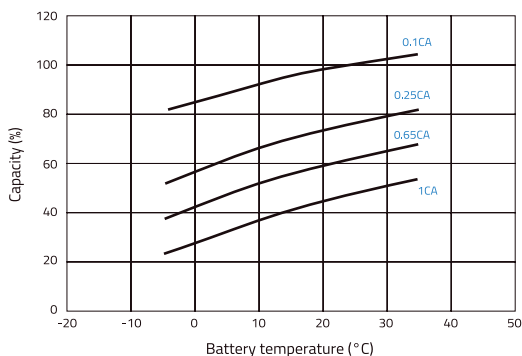

TEMPERATURE ON LONG TERM FLOAT LIFE

