

FDCT12-120

Datasheet

FULBAT®
DEEP CYCLE BATTERY



TUBULAR

FDCT Tubular Series are Deep cycle liquid electrolyte batteries specially designed for demanding applications requiring long service, high cycling performance and intensive discharge requirements. Built with positive tubular armor plates, the FDCT range delivers very high discharge capability and increased endurance, even under poor charging conditions. Thanks to their high productivity in severe working environments, FDCT Tubular batteries are ideally suited for applications such as aerial work platforms, electric stackers, cleaning machines and solar energy systems.

FEATURES

- Excellent tubular plate construction with free electrolyte ensures long operating life
- Very high cycling performance : Up to 1200 cycles (EN 60254-1 / 25°C – for traction battery)
- High discharge capability
- Excellent vibration resistance
- Increased endurance even in cases of poor charging conditions
- High productivity under severe working conditions

TERMINAL

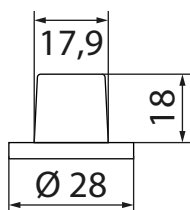

SPECIFICATIONS

Voltage	Capacity	Reserve capacity
12 V	155 Ah (100hr)	292 min (25A)
	140 Ah (20hr)	65 min (75A)
	120 Ah (5hr)	

OPERATING TEMPERATURE

Discharge	-30°C ~ 45°C
Charge	0°C ~ 45°C
Storage	0°C ~ 25°C

CHARGING INSTRUCTIONS

Max current	24A
Float	13.44V
Cyclic	14.4V - 15.9V

DIMENSIONS & WEIGHT

Length	344±2mm
Width	175±2mm
Total Height	285±2mm
Gross weight	41kg

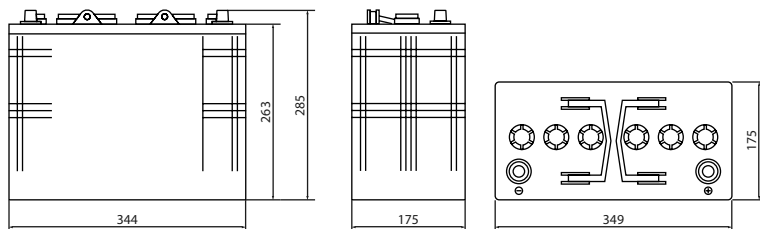

APPLICATIONS



Aerial work platform



Golf cart



Floor cleaning machine



Solar

FDCT CHARGING PROFILE

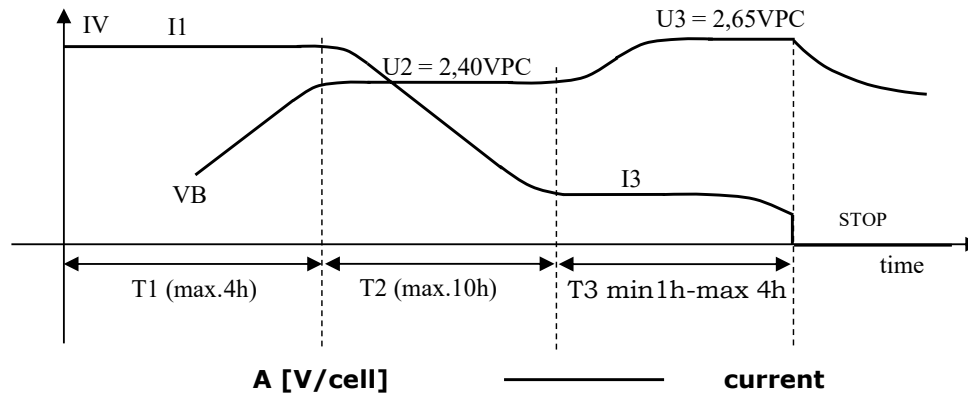

RELATIONSHIP OF TEMPERATURE & CAPACITY

Temperature Vs Capacity (5h)

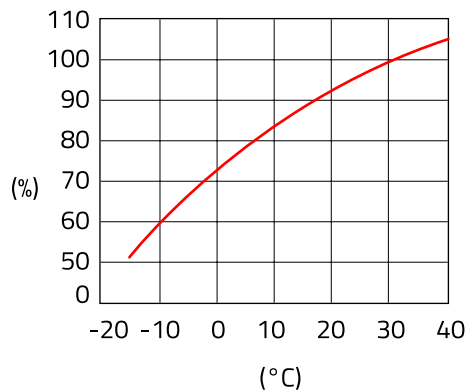

DISCHARGE RATE

Different Hour Discharge Rate Feature Curve

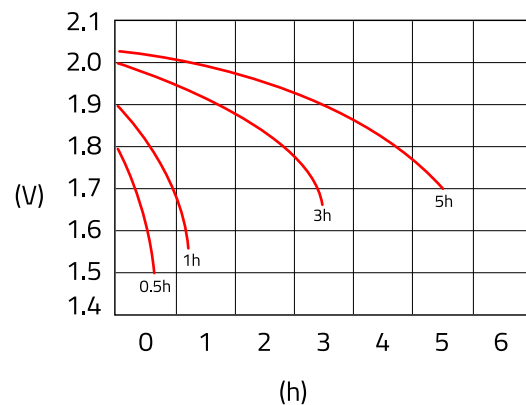

CYCLE LIFE IN RELATION TO DEPTH OF DISCHARGE

Curve for life cycles Vs DOD

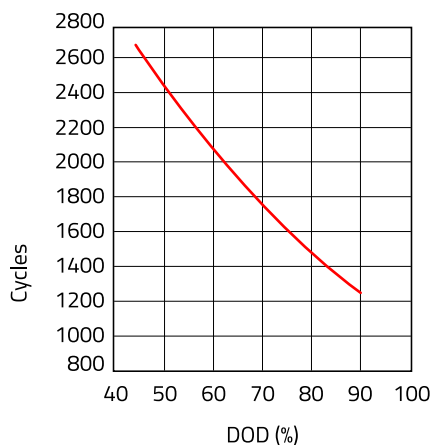

CHARGING VOLTAGE VS CHARGING TIME

Charging Voltage Vs Charging Time

